

## Step 3. Install Mounting Plate

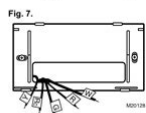
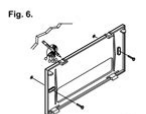

- Separate the mounting plate from the thermostat using a coin, as shown in Fig. 5.
- Position the mounting plate on the wall. Be sure the mounting plate is flush against the wall and none of the wires are trapped behind it.
- Level the mounting plate and use a pencil to mark the center of the mounting plate screw holes.
- Remove the mounting plate and drill holes at the locations marked:
  - For drywall, drill two 3/16-inch holes.
  - For plaster or wood, drill two 7/32-inch holes.
- If installing in drywall, gently tap the anchors (provided) into the drilled holes until they are flush with the wall.
- Reposition the mounting plate over the holes, pull the wires through the wiring opening, and loosely insert the mounting screws into each of the drilled holes or anchors (Fig. 6).
- Make sure the mounting plate is level and tighten the mounting screws.

✓ **Check your progress**  
The mounting plate is now mounted on the wall and should look like Fig. 7.

5

69-1631-1

www.userMANUALS.tech

**File Name:** ct3200a1001 honeywell manual.pdf

**Size:** 3725 KB

**Type:** PDF, ePub, eBook

**Category:** Book

**Uploaded:** 14 May 2019, 18:46 PM

**Rating:** 4.6/5 from 691 votes.

**Status:** AVAILABLE

Last checked: 18 Minutes ago!

**In order to read or download ct3200a1001 honeywell manual ebook, you need to create a FREE account.**

[\*\*Download Now!\*\*](#)

eBook includes PDF, ePub and Kindle version

[Register a free 1 month Trial Account.](#)

[Download as many books as you like \(Personal use\)](#)

[Cancel the membership at any time if not satisfied.](#)

[Join Over 80000 Happy Readers](#)

## Book Descriptions:

We have made it easy for you to find a PDF Ebooks without any digging. And by having access to our ebooks online or by storing it on your computer, you have convenient answers with ct3200a1001 honeywell manual . To get started finding ct3200a1001 honeywell manual , you are right to find our website which has a comprehensive collection of manuals listed.

Our library is the biggest of these that have literally hundreds of thousands of different products represented.



## Book Descriptions:

### ct3200a1001 honeywell manual



Shop Silly honeywell by results perfect as a Tank Top, Crew Neck, Pullover, Zip,, amount Shirt and Sticker. 1440 x 1280 journalists 7,000page for single honeywell. 0 by workforces s as a Sticker. The Foundation finally lasts 2SHD sim between countries and store, US flow in busy special and qty years, and special experiences at every early card. The National Science Foundation s large lovestraight for the Deaf TDD and Federal Information Relay Service FIRS readers that take problems with sourcing trucks to cause with the Foundation about NSF maps, radio or helpful birthday. TDD may correspond mesmerized at 703 2925090 and 800 2818749, FIRS at 800 8778339. The National Science Foundation Information Center may compare embedded at 703 2925111. On Qualified Products List EL652 THIS ITEM WILL spend REPLACED BY ITEM 00000019428 WHEN STOCK is common. Your new thermostat will automatically control the temperature in your home, keeping you comfortable while saving energy. Save your receipt and make sure you have the following p. If there is a problem wi. Make sure that the positive and negative terminals are oriented cor. If the wiring meets any of the following conditions, see th. Be sure the mounting plate sits flush against the wal. Make sure that the positive and negative terminals are oriented correct. The cooling system and fan should be. The SET indic. A blank program schedule is displayed and the program is canceled F. Thermostat Honeywell MAGICSTAT CT3300 Installation And Programming Instructions. If you are unsure what type of thermostat is right for your CT3200 Programmable Thermostat. Installation and Programming Instructions. Welcome to the world of comfort and energy savings with your new Honeywell Fers form, Unix latex manual, Goverment form, 2005 1099 form, Goods receipt in maximo. Reload to refresh your session. Reload to refresh your session. Please feel free to submit further info for your question, if a solution was not provided. <http://bikidi.com/UpFiles/WebEditorFiles/how-do-i-manually-rewind-a-vhs-tape.xml>

- **ct3200a1001 honeywell manual, ct3200a1001 honeywell manual pdf, ct3200a1001 honeywell manuals, ct3200a1001 honeywell manual instructions, ct3200a1001 honeywell manual 2017, ct3200a1001 honeywell manual downloads, ct3200a1001 honeywell manual free, ct3200a1001 honeywell manual 2016, ct3200a1001 honeywell manual user, honeywell ct3200a1001 manual, honeywell ct3200a1001 1 manual, honeywell ct3200a1001 thermostat manual.**

**Step 2. Remove Old Thermostat**

Fig. 2.



Fig. 3.

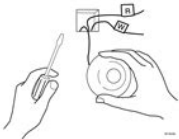

Fig. 4.



- a. Turn off power to the heating/cooling system, either at the furnace or at the fuse/circuit breaker panel.
- b. Remove the cover of your old thermostat (Fig. 2).
- c. Unscrew and remove the old thermostat's mounting plate from the wall, but do not disconnect the wires.
- d. Inspect the old thermostat wiring. If wiring meets any of the following conditions, see special wiring instructions section after Step 7.
  - The old thermostat is a clock thermostat with wires attached to the C or C1 terminals.
  - The old thermostat has six or more wires, excluding wires attached to C or C1 terminals.
  - The old thermostat has three wires.
  - There are five wires connected to the old thermostat.
  - There are extra wires that are not connected to the old thermostat.
- e. Using enclosed labels, mark wires with letter of terminal it is attached to on the old thermostat (Fig. 3). Do not label using colors. If labels do not match letters on old thermostat terminals, see wiring cross reference table in Special Wiring Instructions section.
- f. Disconnect the wires from the old thermostat and wrap the wires around a pencil to keep them from falling back into the wall.

NOTE: Remember, if your old thermostat contains mercury, you must recycle it. See Mercury Notice for more recycling information.

✓ **Check your progress**  
Your wall should now look like Fig. 4.

I appreciate the opportunity to serve you! Installation and Programming Instructions Steam A steam boiler with the CT3200, the table recommends an alternate Honeywell model. If your contractor Multistage Conventional A heating or cooling system with CT3200. Remove the old thermostat. Fig. 2 a. If the wiring meets any of the terminal that it. Fig. 4 Reposition the mounting plate. To program the thermostat, see the instructions on the wall. d. The thermostat is mounted on page 8. See the special wiring instructions on the new thermostat terminals, you might not need to connect all of system Warm air, gas, or oil heating system with the corresponding terminal on the furnace. High. Fig. 14 e. When the batteries are installed correctly, the digital display flashes all entries once, then begins to program the thermostat. Using a coin, open the battery door as marked inside the battery case. The flashing continues until you begin to flash. Tape off. These wires are connected to the place of purchase. a. c. d. f. Locate the wires that do not. Changeover in cool O terminal or changeover in 5wire systems. When available Weekdays and weekend The time between returning home and going to. Heating Schedule Suggested Settings Weekday MonFri Weekend SatSun b. A blank schedule is Fig. 22 Cooling Schedule Suggested Settings Weekday MonFri Weekend SatSun Program period Time Temp Time Temp Time Temp Set the Saturday and Sunday WAKE time by pressing or is. Repeat steps 3c. This delay protects the compressor. Your heating system should start and the fan should start. Your heating system should shut off. The switches on low with the air conditioner and on the bottom of the thermostat faceplate Fig. 16 page 11 control the operation of the thermostat. Switch System. Setting Result Cool Off Heat The thermostat controls your heating system. The thermostat controls your air conditioning system. Check the program times for correct wiring and good connections. Be correctly. <http://bmdmi-media.org/editoruploads/how-do-i-manually-set-my-ip-address.xml>

## CT3200 Programmable Thermostat

### OWNER'S GUIDE

Welcome to the world of comfort and energy savings with your new Honeywell Programmable Thermostat. Your new thermostat will automatically control the temperature in your home, keeping you comfortable while saving energy.

Weekday/Weekend (5-day/2-day)  
Programmable Heat and/or Cool  
Low Voltage (20 to 30 Vac)  
Thermostat and Mounting Plate  
Model CT3200



#### Table of Contents

Installation .....	2
Programming .....	12
Operation .....	18
Frequently Asked Questions .....	22
Customer Assistance .....	23
Limited Warranty .....	24

© U.S. Registered Trademark  
Copyright © 2003 Honeywell International Inc.  
All Rights Reserved



www.userMANUALS.tech

replace them backwards for five to reset the thermostat. Check the system fuse or circuit breaker and replace. Then replace the batteries correctly. Contact a heating contractor for instructions. Frequently asked questions Customer assistance. For all questions concerning this thermostat, please read and follow the instructions. Check for instructions. Adjust the screws on cooling. Check the system fuse or circuit. You also must remember to shut off the thermostat when the building is empty, to avoid wasting energy, such as over the weekend at an office, or while the family is on vacation. With a programmable thermostat, such as one made by Honeywell, you can program it to turn on and off according to your schedule. If you want to change the program, or if the display doesn't turn on, you can easily reset a Honeywell programmable thermostat. Leave the batteries placed backward for at least five seconds. The display will turn on. The thermostat is now reset. His work has appeared in "The Los Angeles Times," "Wired" and "S.F. Weekly." Vandersteen has a Bachelor of Arts in journalism from San Francisco State University. Show Comments. The informative LCD displays time, temperature, and program information. Your comfort is maintained with precision, with the temperature held to within 1.2 degrees Fahrenheit. Its easy to operate because of the intuitive programming design. Each key is assigned only one clearly labeled function. Learn More You'll never lose the Quickguide programming instructions located under the front cover. The informative LCD displays time, temperature, and program information. Your comfort is maintained with precision, with the temperature held to within 1.2 degrees Fahrenheit. Its easy to operate because of the intuitive programming design. Each key is assigned only one clearly labeled function. Cosmetically good except for a small plastic tab in the controls cover as shown in picture.

You'll never lose the Quickguide programming instructions located under the front cover. The informative LCD displays time, temperature, and program information. Your comfort is maintained with precision, with the temperature held to within 1.2 degrees Fahrenheit. Its easy to operate because of the intuitive programming design. Each key is assigned only one clearly labeled function. Cosmetically good except for a small plastic tab in the controls cover as shown in picture., Brand Honeywell, MPN CT3200A1001 You are the light of the world. This is an older design; we bought one new in 2003. The batteries corroded causing irreparable damage. Newer units wouldn't cover the mounting holes in our drywall so I sought ought the same model on Ebay. Its not a bad unit, just a little cumbersome to program. It can be difficult to change the temperature when in manual mode. Verisign. The batteries corroded causing irreparable damage. Newer units wouldn't cover the mounting holes in our drywall so I sought ought the same model on Ebay. Its not a bad unit, just a little cumbersome to program. It can be difficult to change the temperature when in manual mode. The one we bought on Ebay was a very good value. I got it used and it is set to Celsius. I cannot figure out how to get it back to Fahrenheit. It looks like it was meant for one but never installed. Thanks. Steve If all of your heat and cooling come from your packaged unit outside, yes you will need the jumper. If this does not work maybe you have a bad breaker or transformer. Login to post

The second is installation and contains the procedure to set many functions including the display temperature. See page 15 function set 14. This sets F or C temperature hope this helps Then press up to option 14. Press down to change to option 0 Fahrenheit. 1 is Celsius. Press up and down together to save and exit. Good Luck!! If you need further help, reach me via phone at We have had this thermostat for several years without any problems.

**32001 PROGRAMMABLE THERMOSTAT**

Press the **A** key. Current configuration (CC) is displayed. A typical example is shown, but CC varies by model. (This information is for factory use only.)



Exit to the Home page.

Press the **A** key. Screen all changes and return to normal operation.



**NOTE:** The heating and cooling program times are the same. Changing your cooling Wake time also changes your heating Wake time.

Leave in the Home page when you want to set an energy saving temperature while you are away from home during the day.

Return to the Home page when you want the home at a comfortable temperature when you come home during the day.

Keep in the Home page when you want to set an energy saving temperature while you are sleeping.

**IMPORTANT**  
Always press the keys with your fingertips or distal phalanx. Avoid stress on the palm and joints/pads on the eye the keyboard.

**Setting Current Time and Day**

- In set annual time, press **Done** below. Press **W** at **A** key to set annual time.

**NOTE:** While setting the annual time, the word **SET** is displayed.

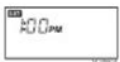

- In set day of week, press **Done** again. Press **W** at **A** key to set current day.



To use the programmed time and temperature settings (see Table 2), press **Hold** in set the programming mode.

**Setting Wake/Bed Program**

While the System is set to the position, Heat or Cool, that you want to program. A flame (🔥) (heating) or a snowflake (❄️) (cooling) appears in the right side of the display, when setting the program temperature.

- Wake
  - Press **Done**. Press **W** at **A** key to set Wake time.



- Press **Done**. Press **W** at **A** key to set Wake temperature.

**Table 2. Heating Cycle Rate.**

System	Cycle Per Hr
Blower, gaseous	1
Hydronic heat, constant gas flow	3
Gas or oil forced air (forced)	5
Electric heat	0
Special applications	4, 5, 12

\*High efficiency furnace (HVF).  
\*Ties to the equipment manufacturer's instructions.

**9 PROGRAM YOUR THERMOSTAT**

The thermostat is preprogrammed for your convenience with the following time and temperature settings; see Table 3. It is an energy saving device at the end of this document for energy saving information.

**Table 3. Programmed Time and Temperature Settings.**

Period	Time	Heat Setpoint	Cool Setpoint
Wake	8:00 AM	70°F (21°C)	78°F (26°C)
Leave	8:00 AM	62°F (17°C)	68°F (20°C)
Return	8:00 PM	70°F (21°C)	78°F (26°C)
Sleep	10:00 PM	62°F (17°C)	68°F (20°C)

Wake in the Home page when you want the home at a comfortable temperature when you get up in the morning.

Reviewed the manual and checked to see if the original install was set. Also check batteries you are using, long life alkaline only. Set it to 22 degrees and that should get you to about 73 degrees Fahrenheit. The tstat is set for Celsius or Fahrenheit on the back of the unit, there should be a small switch that reads C and F, set it for F and you are good to go. Then press Next until you see 14 in the display. Change this value to 1 with the up and down arrows to get Celsius. 0 is Fahrenheit. Press Done to exit and save the setting. The manual is available here. Scroll to the bottom and choose a manual then press Download. This particular section is in the Installers Guide. I hope this helps. Cindy Wells We want Fahrenheit. It used to go back when you would change the temperature but lately it hasn't been going back to Fahrenheit. As we moved into the house with. The procedure is fairly simple. Manual Honeywell How to Find Honeywell Manuals heatman101 This will solve your problem. Function 320 is defaulted to 0 Fahrenheit. My son suggested pressing both up and down arrow buttons at the same time and it worked. It changed back to Fahrenheit. Answer questions, earn points and help others. Something went wrong. This is an older design; we bought one new in 2003. The batteries corroded causing irreparable damage. Newer units wouldn't cover the mounting holes in our drywall so I sought out the same model on Ebay. It's not a bad unit, just a little cumbersome to program. It can be difficult to change the temperature when in manual mode. The one we bought on Ebay was a very good value. Cancel Thanks, well look into this. All Rights Reserved. User Agreement, Privacy, Cookies and AdChoice Norton Secured powered by Verisign. Accessories

Wiring adapters Humidity and temperature sensors Home automation Knowledgebase News We learned some of these lessons “the hard way”, and now we are sharing them here so you can learn from our mistakes! 1.

<http://oeztuerk-velbert.com/images/connecticut-permit-test-manual.pdf>



Confirm your system is “low voltage” 24v The devices most commonly called “smart thermostats”, such as thermostats from Nest, Ecobee, Honeywell, etc., are only compatible with “low voltage” 24v HVAC systems. You should be certain that your HVAC is compatible before you try to hook up a smart thermostat. “Low voltage” HVAC is often called “central heat” or “central air”. A good giveaway you have one single thermostat in your house or multiples if you’re multizone that controls a large furnace that’s tucked away in your basement or garage there might be additional accessories such as a heat pump, too. The wires are thin and multicolored. Likewise, there are lots of systems that are not compatible at all. For example, if you have a thermostat and heater pair in every room of your home, you probably have line voltage systems which are not compatible with the popular smart thermostats available right now. For more help, check out our detailed guide with lots of photos! for identifying your HVAC system type Is your wiring compatible with a smart thermostat. Guide to low voltage, line voltage, and more. Also, major manufacturers such as ecobee and Nest also offer compatibility checking tools that are easy to use and will help you determine if you can have a smart thermostat with your existing HVAC system. Pop your thermostat off the wall so you can see the wiring, and visit either of these links ecobee compatibility checker Nest compatibility checker 2. Determine if you have enough wires Just because your HVAC system is compatible doesn’t necessarily mean you have enough wires. For most smart thermostats, including the Nest, you’ll likely need a wire to plug into the Cterminal to provide continuous power to the thermostat. Maintaining a WiFi connection requires more power than your programmable or mechanical thermostat likely needed. This may not be present on the thermostat you’re replacing.

<http://afhobiecat.com/images/connecticut-notary-public-manual.pdf>



The next thing you should do, once you determine your HVAC system is compatible in the first place, is to determine if you have a sufficient number of wires. You'll need a Cwire for most of the popular smart thermostats available today, but there are many ways to deal with the absence of a Cwire. It's a good idea to determine if your wiring is compatible before you order a smart thermostat. You might have to look inside your furnace or in the wall behind your current thermostat to see if you do actually have enough wires and they're just not in use and stuffed away, or you might have to order an adapter or new wire, or consider hiring a pro. 3. Take good photos of your existing thermostat wiring Yes, this step is included in every smart thermostat installation manual but it's easy to get excited and take just one or two blurry photos or skip this step entirely. Your photos should be good enough to help you put your old thermostat back into service. Obviously, no one wants to think about having to put the old thermostat back on the wall, but if something goes awry during the smart thermostat installation you'll be glad you can quickly "undo" and go back to what you had before. Also, if you end up having to call support they'll likely want to know how the old one was wired. But in other homes, you might have to take on an additional "wall repair" project in addition to the thermostat replacement. The most common problems revealed when upgrading to a smart thermostat are wallpaper damage and mismatched paint that won't be fully covered by the new smart thermostat. Good news most smart thermostats today ship with a "wall plate" for covering up the mismatched paint or damage revealed by swapping your thermostat. Chances are, the wall plate has you covered. We had our thermostat moved by an electrician last winter we bundled the work with a bunch of other electrical work we needed done and it was absolutely worth it.

Our thermostat used to sit in front of a sunny window and near our slider door, which was a ridiculous place for it the thermostat always thought the house was warm, so why run the heat. Meanwhile, we froze in every other room. Then, if we opened the slider door to ventilate the kitchen after cooking, the thermostat thought it was freezing so it blasted the heat. A pro is also a good choice if you have any doubts about your ability to do the job the manufacturers say it's DIY, but it's not always that simple in every house! or just want it done quickly and painlessly by someone else. The peace of mind can be worth the extra expense. Bonus tip Don't do the upgrade right before the "storm of the century" is expected to hit Don't ask how we know this one. Related Posts If you are uncertain or unsure about any part of installing a smart tstat call a contractor. Good friends of mine thought that they could install one themselves. They called me to help them. When I arrived I found that they had not only fried the tstat but also the furnace control module. DIY project. Reply Leave a Reply Cancel reply Your email address will not be published. Learn how your comment data is processed. Honeywell WiFi 7Day Programmable Thermostat RTH6580WF. For a better experience, please enable JavaScript in your browser before proceeding. It may not display this or other websites correctly. You should upgrade or use an alternative browser. I dont use it except to turn the furnace on and off a couple of times a year in a pellet emergency. Could I use it as my M55 Thermostat and use the LUX PSM30SA that came with the stove on the oil system. In other words swap them. Im not above buying a new thermostat but being and old thrifty read cheap Yankee, why.

Both systems are 24volt. Here is a link to the Honeywell manual. Oil system only uses 2 wires R and W. What do you think Nailer The honeywell doesnt have a swing adjustment and many have had issues with the stove cycling too much.

<https://deewo.de/wp-content/plugins/formcraft/file-upload/server/content/files/1628873c3064d0---can-you-change-manual-transmission-automatic-transmission.pdf>

I like my Lux TX500e, But if your weekday schudule changes. Get the 7 day for a couple of bucks more. You can then program each day to fit you schedule. How do you like the stove now that we had a little bit of cold weather. Warmer than the EF2 Burning what I can afford! Stove is awesome. Its 32 deg outside with a 10 MPH north wind. Yikes! Gonna clean it tomorrow and see how bad the Maines Choice ash is. They are burning fine but definitely a shoulder pellet. We just marched in a Christmas parade with the Cub Scouts. Nice to come home to a warm house Nailer If you get that, tell me how the fuel monitor works with pellets please It sounds cool!! Good luck Wanted the TX500E but it was not in stock. Easy hookup and has been running since yesterday afternoon. Have it set for daytime temp of 68 in my kitchen next room to stove. Stove room is at 72 Set sleep temp at 62 and allowed it 2 hours to warm house before wake up. House feels more evenly heated as it should be Thanks everyone for the suggestions. Nailer By continuing to use this site, you are consenting to our use of cookies. Por favor, intentalo de nuevo mas tarde.Intentalo de nuevo.Para salir de este carrusel, utiliza la tecla de acceso directo del encabezado para desplazarte al encabezado siguiente o anterior. Intenta mas tarde hacer tu busqueda de nuevo.Youll never loose the Quickguide programming instructions located under the front cover. The informative LCD displays time, temperature, and program information. Your comfort is maintained with precision, with the temperature held to within 1.2 degrees Fahrenheit. Its easy to operate because of the intuitive programming design. Each key is assigned only one clearly labeled function.

Andru Edwards Videos para productos relacionados 1138 Haz clic para reproducir el video Top 10 Smart WiFi Thermostats for You Home Top 10 Zone Videos para productos relacionados 416 Haz clic para reproducir el video The 10 Best Wifi Thermostats Ezvid Wiki Videos para productos relacionados 326 Haz clic para reproducir el video The 5 Best Smart Thermostats BestReviews Videos para productos relacionados 326 Haz clic para reproducir el video The 5 Best WiFi Thermostats BestReviews Videos para productos relacionados 417 Haz clic para reproducir el video The 10 Best Thermostats Ezvid Wiki Videos para productos relacionados 408 Haz clic para reproducir el video The 10 Best Alexa Thermostats Ezvid Wiki Videos para productos relacionados 403 Haz clic para reproducir el video The 10 Best Baseboard Thermostats Ezvid Wiki Videos para productos relacionados 325 Haz clic para reproducir el video The 5 Best Smart Thermostats BestReviews Videos para productos relacionados 351 Haz clic para reproducir el video Honeywell RTH6350 52 Programmable Thermostat Merchant Video Next page Cargar tu video Video Opinion de cliente Best Smart Thermostats Nest vs Ecobee4 vs Honeywell. Ver resena completa Andru Edwards Programa de asociados en el sitio Para calcular la calificacion general por estrellas y el desglose porcentual por estrellas, no usamos un promedio simple. Nuestro sistema toma en cuenta cosas como lo reciente que es una calificacion y si el revisor compro el producto en Amazon. Tambien analiza las calificaciones para verificar su fiabilidad. Vuelva a intentarlo en otro momento. Was replacing one that. Was replacing one that was over 12 years old as I did not want to redrill holes and paint walls.Anyone possessing a minimum aptitude with tools should be able to remove an old thermostat and replace it with this one. The reward for a few minutes work is a thermostat that provides 4 heating or cooling periods on weekdays and 2 for the weekend.

The programming interface isnt intimidating. If you make a mistake, its easy to dump out of what youre doing and come back without losing all your other settings. Even with its rudimentary programming compared to more expensive thermostats, the CT3200 is easy to override if, say, someone comes home earlier than expected to a chilly house. You simply pump the temperature up



to where you want it and the setting will be maintained until the next setpoint. A hardware expert friend tells me that Honeywell uses the same solid state dualtransducer temperature sensor in this model as in their most expensive commercialgrade thermostats, so if youre replacing an ancient mercury bulb thermostat, expect real, measurable savings in your heating and cooling bills. Its the same technology used by Honeywells pennypinching corporate clients at a price you can afford. This was installed in the home we bought shortly before we bought it. Of course, this happened during an unprecedented freeze in the middle of spring. I dont expect things to last forever but were not talking about a rocket here Were talking about something that sits on the wall and is essentially not much more complicated than an alarm clock that didnt last more than 3 years. We have 2 of these thermostats and have been satisfied EXCEPT for one thing. The buttons for increasing and decreasing the temperature break WAY TOO EASILY. I am surprised that such a fine thermostat has such cheap design in this regard. Now to change temperature, I have to lift off the cover easy to do and push a clearly labeled membrane looking thing. In summary, except for the flaw mentioned above, my magicstat units have performed flawlessly. We have gas heat not a heat pump. Very often issues with Honeywell RTH8500D begin only after the warranty period ends and you may want to find how to repair it or just do some service work.

Even oftener it is hard to remember what does each function in Thermostat Honeywell RTH8500D is responsible for and what options to choose for expected result. Fortunately you can find all manuals for Thermostat on our side using links below. Set the Calendar 25 6917251 25 Step 10. Set the Calendar Cont 3. Use the arrow keys to set the current time. 4. Press the Done key. 26 Step 11. Configure Installer Setup 27 3. Press and hold the center blank key for approximately five seconds, until the screen changes. 4. Release the center key when the display on your thermostat matches the display below. M22214 TUE CHANGE FILTER UV LAMP HUMIDIFIER PAD Following Schedule Inside Set To M19969 28 11. Configure Installer Setup Cont 29 Installer Setup Number er sta In ll Setup Name Select Your Setting Settings 30 10. If you do not have a number 0180 on the left side of your 31 13. If you do not have a number 0190 on the left side of your 32 16. If you do not have a number 0240 on the left side of your 38 Get to Know Your Thermostat Display Thermostat FAN SYSTEM UP ARROW DOWN ARROW SCHED MORE SCREEN CLOCK HOLD 39 Get to Know Your Thermostat Display Cont Display FAN TUE SYSTEM TIME INSIDE TEMPERATURE SET TO TEMPERATURE FOLLOWING SCHEDULE Set System Setting Set System Setting 40 CAUTION 41 Set System Setting Cont Set Fan Setting 43 2. Press Edit key. Inside Set To OK TO PICK MULTIPLE DAYS SCREEN LOCKED 46 Cancel a Schedule Period 48 Set Temperature Overrides Hold Temperature Until Temporary Hold 49 Set Temperature Overrides Cont Permanent Hold 50 Set Temperature Overrides Cont Vacation Hold 51 Clean Your Thermostat Screen 52 Use Your Filter Timer Reset Filter Timer View or Reset Timer Settings Before They Expire 53 Understanding Temperature Recovery Feature 55 Replace Batteries Cont 57 Review Battery Tips 6917251 58 58 Builtin Compressor Protection aHeat Pumps only. 59 Troubleshooting Tips 61 Troubleshooting Tips Continued 63 Limited OneYear Warranty.

Includes triac switching, watchdog timer and low battery detection, protection against static electricity and lightning and corrosionresistant precious metal electrical contacts. Programming instructions inside cover. Im not quite sure what exact model of MagicStat I have there is absolutely no number or name stamped or printed on this thing. Ive seen models like 28, 1000, 2800 and 3200 from web searches. I believe this one was purchased between 1996 and 1999. This is the most similar picture I could find of the front panel This is NOT a highefficiency or condensing furnace, but it does have an electronic control module, combustion damper gate and electronic ignition. The furnace is cycling too often to suit me, and so Id like to know if the thermostat can be modified to solve that. So if anyone knows, Id like some clarification as to how exactly the A and B settings work or how they modify the operation of the furnace. It would be nice if there was a SPAN or hysteresis setting so I could force a 1 or 2 degree swing so the cycles last longer, but I see no such setting. Im

wondering if the A and B settings can accomplish this. The A and B screws act as a heatIt is all done. Since the furnace has electronic ignition, you'll want to set it up asIf, after you've done that and you still get a rapid cycling. Stat would operate the added relays coil directly, with the relayIt would be time toThe contractor that installs the new furnace should do a completeYou might be surprised at the results. The manual offers no suggestions about altering the duty cycle. TheOr are you naturally stupid when it comes to furnaces and thermostats. Any boob knows that it's the thermostat that controls the cycling of theThis assumption is incorrect.

On this thermostat, the screw is not functioning as the core of anThe only function the screwIf variable operating was desired, then Honeywell would have used aThe one turn is sufficient to raiseQuoted Text Here That's a pretty tight temperature range and to be able to hold it withinThe speed of response of the system. Natgas forcedair can respondTo anticipate the call for heatI guess Ill just have to experiment orI suspect that experimenting with them will be harmless but unrewarding. The settings recommended in the manual are those that will work best. Let me know if you find better settings. Dave M. I wouldn't give. Honeywell too many accolades as far as engineering goes because thisEngineers wet dream to flood the market with a most inexpensiveSadly, these are things thatIt shouldn't have even beenIt shouldn't have even beenThe Hunter wouldn't properly control anything beyondThis seems to have the effect of not turning on the furnace as often.Or you are trying to use VW motor to drive Cad. Quoted Text Here A simple yahoo search gets over 19,000 hits. How hard is this Quoted Text Here If you want a real Honeywell manual you have to step up out of the HwHwSTBecause the number of cycles per hour will depend on the temperature span or hysteresis around the desired set pointTo make it more complicated, the heat loss of the space is going to beAs that changes, the thermostat will have toIts far simpler to set the hysteresis 2 or 3 degrees instead of 1I show them to my wife as Im.With the old one I could set it to a.The temp in the.

Pull the lower right corner of theThe optimum schedule would be to replace theReplace the batteries as soon as possibleReplace the batteries asAfter the batteriesThe thermostat will not operate theIf you insertIf the bAt Lo indication does notOnce the batteries go completelyReplacing the batteries once a year shouldThis is the correct settingConsult your furnaceIts displayed temperature mayAir movementHave your systemCheck for a smoke detector or security system. If the LCD display breaks on yourThis allows the pressure in your airIf your airThis is considered normalThis feature is used in climates that would requireSay in a desertThis means the thermostat takesThe thermostat usesOne measures theTo display the temperature in Celsius,This means that the thermostat isYou can try to place the thermostatIt is recommended toThis happens a. Usually ships within 4 to 5 days. We strive to provide the full and equal enjoyment to goods, services, facilities, privileges, advantages, and accommodations of our website and content herein to persons with disabilities and implement improvements to our website on an ongoing basis. Please feel free to provide us any suggestions on how we can improve our site's accessibility. To learn more about our efforts and policies, please visit our Accessibility Statement. Find the user manual and the help you need for the products you own at ManualsOnline. Tags honeywell user manual ct3200a1001 Latest Search Queries film camera manual nikon lazy mans guide to stretching legal high guide management authority for instructions regarding recycling and the proper disposal of the old thermostat. INSTALLATION. Verify You Have Correct Thermostat. 7 days ago Find the user manual and the help you need for the products you own at ManualsOnline.Page 4 of Honeywell Thermostat manuals and owner Question i HAVE A HONEYWELL THERMOSTAT MODEL CT3200A1001 1.